



7102 and 7115 Series

Pro Series 150 1 1/2" and 2" Solenoid Valves

Feature a removable inlet cap to easily modify the configuration from globe to angle style.
Alternate to Irritrol 216b and 217b.

Features:

- Heavy duty, corrosion & UV resistant PVC construction increases the life of the valve.
- External bleed screw with removable metering pin allows for cleaning of the pin without disassembling the valve.
- Manual external bleed screw allows for manual operation in system start-up.
- Manual internal bleed through solenoid allows for manual operation without leaking water.
- Removable inlet cap allows for easy conversion from globe to angle style valve.
- Flow control allows for precise flow adjustment and manual shutoff.
- Captured plunger solenoid allows for the solenoid to be removed without losing the plunger.
- Heavy duty santoprene diaphragm design improves durability.
- 5 year Limited Warranty.

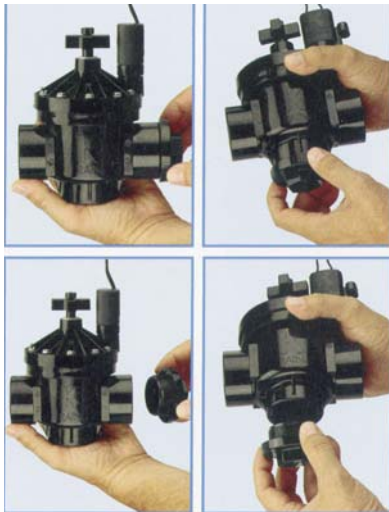

System Flexibility

Specifications:

- Dimensions: 1 1/2" valve: 8" H x 4 1/4" W x 5 1/2" L
2" valve: 8 7/8" H x 4 7/8" W x 6 1/3" L
- Flow range: 5-120 GPM
- Pressure Rating: 20-150 PSI
- Solenoid: 24 VAC 60 cycle
- Inrush Current: 0.4 Amps
- Holding Current: 0.2 Amps

Performance Data:

GPM		20	30	40	50	60	80	100	120
ProSeries 150 1 1/2" valve									
PSI LOSS	globe	3.0	2.6	2.3	2.9	4.1	5.5		
	angle	2.7	2.2	1.9	2.2	3.0	4.4		
ProSeries 150 2" valve									
PSI LOSS	globe	2.0	1.9	1.7	1.5	1.6	2.9	4.8	6.2
	angle	1.9	1.9	1.7	1.5	1.5	2.1	3.2	4.6

Part Number	Description	Ctn Qty	List Price
7115	1 1/2" Female Thread, NPT	6	\$ 168.96
7102	2" Female Thread, NPT	6	221.54