



Malleable Iron Fittings - Domestic

Domestic Malleable Iron Fitting Features:

- Class 150 malleable iron pipe fittings
- Suitable for water, steam, air, gas and oil
- All fittings are air pressure tested
- Working pressure:
 - Max: 300 psi @ -20°F to 150°F
 - Min 150 psi @ 366°F
- Made in USA

Malleable Iron Fitting Specifications:

Material:	ASTM A197
Dimensions:	ANSI/ASME B16.3 ANSI/ASME B1.20.1
Pressure ratings:	ANSI/ASME B16.3
Coatings:	ASTM A153, A165

BLACK



BM90L/GM90L Series

Size	Ctn Qty	List Price
90° ELBOW fipxfipt		
BM90L1/8	35	\$ 4.93
BM90L1/4	30	4.81
BM90L3/8	30/180	4.81
BM90L1/2	50/200	3.33
BM90L3/4	35/140	4.03
BM90L1	20/80	6.99
BM90L11/4	20/40	11.52
BM90L11/2	8/32	15.15
BM90L2	8/16	26.12
BM90L21/2	12	58.20
BM90L3	5	85.17
BM90L4	4	182.93

90° ELBOW REDUCER fipxfipt		
BM90L3/8 x 1/4	25	6.76
BM90L1/2 x 1/4	30	6.53
BM90L1/2 x 3/8	50	6.36
BM90L3/4 x 3/8	30	6.53
BM90L3/4 x 1/2	30	6.53
BM90L1 x 1/2	25	9.06
BM90L1 x 3/4	20	8.40
BM90L11/4 x 3/4	15	15.74
BM90L11/4 x 1	10	14.11
BM90L11/2 x 1/2	12	21.81
BM90L11/2 x 3/4	12	22.77
BM90L11/2 x 1	10	19.90
BM90L11/2 x 11/4	15	19.90
BM90L2 x 1/2	10	27.54
BM90L2 x 3/4	15	34.74
BM90L2 x 1	12	32.75
BM90L2 x 11/4	10	32.75
BM90L2 x 11/2	10	28.82
BM90L21/2 x 11/2	12	83.76

GALVANIZED



BM90L/GM90L Reducer Series

Size	Ctn Qty	List Price
90° ELBOW fipxfipt		
GM90L1/8	35	\$ 7.62
GM90L1/4	30	6.96
GM90L3/8	30	6.96
GM90L1/2	50/200	4.49
GM90L3/4	35/140	5.51
GM90L1	20/80	10.20
GM90L11/4	20	16.12
GM90L11/2	8	21.04
GM90L2	8	34.47
GM90L21/2	12	90.20
GM90L3	5	148.71
GM90L4	4	262.28
90° ELBOW REDUCER fipxfipt		
GM90L3/8 x 1/4	25	11.15
GM90L1/2 x 1/4	30	9.66
GM90L1/2 x 3/8	50	8.25
GM90L3/4 x 3/8	30	13.22
GM90L3/4 x 1/2	30	9.58
GM90L1 x 1/2	25	13.05
GM90L1 x 3/4	20	12.29
GM90L11/4 x 3/4	15	24.76
GM90L11/4 x 1	10	20.61
GM90L11/2 x 1/2	12	28.45
GM90L11/2 x 3/4	12	32.94
GM90L11/2 x 1	10	32.94
GM90L11/2 x 11/4	15	32.94
GM90L2 x 1/2	10	36.85
GM90L2 x 3/4	15	46.71
GM90L2 x 1	12	45.77
GM90L2 x 11/4	10	44.12
GM90L2 x 11/2	10	38.50
GM90L21/2 x 11/2	12	145.36
GM90L3 x 2	8	205.95

Case quantities required please for fittings through 2"



In the United States: Phone (800) 776-2266 Fax (800) 729-3299
 In Canada: Phone (866) 503-5523 Fax (888) 562-2095

www.americangranby.com

10/24/08

12.39

Malleable Iron Fittings - Domestic



BLACK

GALVANIZED



BM45L/GM45L Series

Size	Ctn Qty	List Price
45° ELBOW fipxfipt		
BM45L1/4	35	\$ 7.25
BM45L3/8	40	7.25
BM45L1/2	50	5.50
BM45L3/4	40	6.81
BM45L1	25	8.58
BM45L11/4	10	15.16
BM45L11/2	10	18.75
BM45L2	8	28.36
BM45L21/2	15	82.08
BM45L3	8	106.60
BM45L4	4	209.04

Size	Ctn Qty	List Price
45° ELBOW fipxfipt		
GM45L1/4	35	\$ 9.50
GM45L3/8	40	10.60
GM45L1/2	50	7.09
GM45L3/4	40	10.20
GM45L1	25	11.52
GM45L11/4	10	21.52
GM45L11/2	10	25.27
GM45L2	8	37.41
GM45L21/2	15	130.14
GM45L3	8	189.28
GM45L4	4	317.31



BM90SL/GM90SL Series

Size	Ctn Qty	List Price
90° STREET ELBOW fipxfipt		
BM90SL1/8	40	7.10
BM90SL1/4	30	7.10
BM90SL3/8	30	7.10
BM90SL1/2	50/200	6.90
BM90SL3/4	35/140	6.90
BM90SL1	20/80	9.76
BM90SL11/4	15	15.16
BM90SL11/2	12	20.29
BM90SL11/2 x 11/4	16	36.85
BM90SL2	8	32.97
BM90SL21/2	8	83.57
BM90SL3	8	127.57

Size	Ctn Qty	List Price
90° STREET ELBOW fipxfipt		
GM90SL1/8	40	9.97
GM90SL1/4	30	9.65
GM90SL3/8	30	9.65
GM90SL1/2	50	9.86
GM90SL3/4	35	9.86
GM90SL1	20	13.19
GM90SL11/4	15	22.13
GM90SL11/2	15	27.78
GM90SL11/2 x 11/4	16	45.23
GM90SL2	8	46.85
GM90SL21/2	8	135.52
GM90SL3	8	197.24

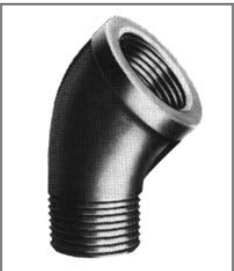

BM45SL/GM45SL Series

Size	Ctn Qty	List Price
45° STREET ELBOW fipxfipt		
BM45SL1/8	30	11.16
BM45SL3/8	30	9.42
BM45SL1/2	50	7.70
BM45SL3/4	40	11.61
BM45SL1	25	13.53
BM45SL11/4	25	23.40
BM45SL11/2	15	30.17
BM45SL2	10	50.72

Size	Ctn Qty	List Price
45° STREET ELBOW fipxfipt		
GM45SL1/8	30	14.52
GM45SL3/8	30	14.30
GM45SL1/2	50	10.84
GM45SL3/4	40	17.21
GM45SL1	25	22.04
GM45SL11/4	25	33.08
GM45SL11/2	15	40.06
GM45SL2	10	65.97



BMT/GMT Series

Size	Ctn Qty	List Price
TEE fipxfiptxfipt		
BMT1/8	35	7.42
BMT1/4	35	6.99
BMT3/8	30	6.99
BMT1/2	30/120	4.45
BMT3/4	20/80	6.39
BMT1	12/48	10.94
BMT11/4	15	17.74
BMT11/2	10	22.05
BMT2	15	37.59
BMT21/2	8	81.05
BMT3	6	119.38
BMT4	3	288.54

Size	Ctn Qty	List Price
TEE fipxfiptxfipt		
GMT1/8	35	10.79
GMT1/4	35	9.09
GMT3/8	30	9.09
GMT1/2	30/120	5.82
GMT3/4	20/80	9.58
GMT1	12	15.48
GMT11/4	15	24.58
GMT11/2	10	30.55
GMT2	15	49.65
GMT21/2	8	139.81
GMT3	6	163.96
GMT4	3	387.85



Malleable Iron Fittings - Domestic

BLACK



BMT/GMT
Reducer Series

Size	Ctn Qty	List Price
TEE Reducing fiptxfiptxfipt		
BMT1/2 x 1/2 x 1/4	25	\$ 7.59
BMT1/2 x 1/2 x 3/4	30	11.42
BMT3/4 x 1/2 x 1/2	30	10.15
BMT3/4 x 3/4 x 1/4	30	11.00
BMT3/4 x 3/4 x 3/8	30	12.14
BMT3/4 x 3/4 x 1/2	25	9.90
BMT3/4 x 1/2 x 3/4	20	11.42
BMT3/4 x 3/4 x 1	15	15.06
BMT1 x 1/2 x 1/2	20	14.23
BMT1 x 1/2 x 3/4	20	16.96
BMT1 x 1/2 x 1	15	14.23
BMT1 x 3/4 x 1/2	20	14.29
BMT1 x 3/4 x 3/4	20	13.22
BMT1 x 3/4 x 1	20	14.49
BMT1 x 1 x 1/4	20	15.80
BMT1 x 1 x 1/2	15	12.48
BMT1x1x3/4	25	12.48
BMT1x 1 x 1 1/4	15	27.64
BMT11/4 x 1/2 x 1 1/4	10	26.50
BMT11/4 x 3/4 x 3/4	10	26.50
BMT11/4 x 3/4 x 1	10	24.54
BMT11/4 x 3/4 x 1 1/4	15	24.01
BMT11/4 x 1 x 1	15	23.30
BMT11/4 x 1 1/4 x 1/2	15	22.75
BMT11/4 x 1 1/4 x 3/4	12	19.94
BMT11/4 x 1 1/4 x 1	14	21.62
BMT11/4 x 1 x 1 1/4	15	27.98
BMT11/2 x 1/2 x 1 1/2	10	31.66
BMT11/2 x 3/4 x 3/4	10	53.07
BMT11/2 x 3/4 x 1 1/2	10	31.66
BMT11/2 x 1 x 1 1/2	10	31.66
BMT11/2 x 1 1/4 x 3/4	10	31.66
BMT11/2 x 1 1/4 x 1	8	27.18
BMT11/2 x 1 1/4 x 1 1/4	10	42.48
BMT11/2 x 1 1/4 x 1 1/2	10	47.75
BMT11/2 x 1 1/2 x 1/2	8	26.66
BMT11/2 x 1 1/2 x 3/4	10	25.18
BMT11/2 x 1 1/2 x 1	10	25.18
BMT11/2 x 1 1/2 x 1 1/4	8	31.13
BMT2 x 1/2 x 2	8	49.37
BMT2 x 3/4 x 2	8	48.51
BMT2 x 1 x 2	8	49.37
BMT2 x 2 x 1/2	10	40.21
BMT2 x 2 x 3/4	10	39.45
BMT2 x 2 x 1	10	39.45
BMT2 x 2 x 1 1/4	8	42.48
BMT2 x 2 x 1 1/2	8	42.48
BMT2 x 1 1/4 x 1 1/4	8	49.37
BMT2 x 1 1/2 x 1 1/4	8	49.45
BMT2 x 1 1/2 x 1 1/2	8	48.51
BMT2 1/2 x 2 1/2 x 2	12	105.43

GALVANIZED

Size	Ctn Qty	List Price
TEE Reducing fiptxfiptxfipt		
GMT1/2 x 1/2 x 3/8	35	\$ 13.50
GMT3/4 x 1/2 x 1/2	30	15.92
GMT3/4 x 3/4 x 1/4	30	14.24
GMT3/4 x 3/4 x 1/2	25	13.33
GMT3/4 x 1/2 x 3/4	20	15.20
GMT3/4 x 3/4 x 1	15	22.92
GMT1x1/4x1	15	24.21
GMT1 x 1/2 x 1/2	20	23.36
GMT1 x 1/2 x 3/4	20	23.87
GMT1 x 1/2 x 1	15	23.36
GMT1 x 3/4 x 1/2	20	23.36
GMT1 x 3/4 x 3/4	20	22.54
GMT1 x 3/4 x 1	20	23.36
GMT1 x 1 x 1/2	15	18.70
GMT1x1x3/4	25	18.70
GMT1x 1 x 1 1/4	15	37.80
GMT11/4 x 1/2 x 1 1/4	10	36.75
GMT11/4 x 3/4 x 3/4	10	40.00
GMT11/4 x 3/4 x 1	10	38.03
GMT11/4 x 3/4 x 1 1/4	15	34.49
GMT11/4 x 1 x 1	15	35.20
GMT11/4 x 1 1/4 x 1/2	15	30.66
GMT11/4 x 1 1/4 x 3/4	12	29.01
GMT11/4 x 1 1/4 x 1	14	29.01
GMT11/4 x 1 x 1 1/4	15	37.22
GMT11/2 x 1/2 x 1 1/2	10	50.55
GMT11/2 x 3/4 x 3/4	10	67.28
GMT11/2 x 3/4 x 1 1/2	10	46.09
GMT11/2 x 1 x 1 1/2	10	46.09
GMT11/2 x 1 1/4 x 3/4	10	46.09
GMT11/2 x 1 1/4 x 1	8	43.57
GMT11/2 x 1 1/4 x 1 1/4	10	63.91
GMT11/2 x 1 1/4 x 1 1/2	10	63.91
GMT11/2 x 1 1/2 x 1/2	8	37.87
GMT11/2 x 1 1/2 x 3/4	10	35.84
GMT11/2 x 1 1/2 x 1	10	35.85
GMT11/2 x 1 1/2 x 1 1/4	8	44.86
GMT2 x 1/2 x 2	8	65.17
GMT2 x 3/4 x 2	8	63.92
GMT2 x 1 x 2	8	65.17
GMT2 x 2 x 1/2	10	58.29
GMT2 x 2 x 3/4	10	52.32
GMT2 x 2 x 1	10	51.35
GMT2 x 2 x 1 1/4	8	61.59
GMT2 x 2 x 1 1/2	8	61.59
GMT2 x 1 1/4 x 1 1/4	8	65.17
GMT2 x 1 1/2 x 1 1/4	8	65.17
GMT2 x 1 1/2 x 1 1/2	8	63.92
GMT2 1/2 x 2 1/2 x 2	12	173.18

Malleable Iron Fittings - Domestic



BLACK

GALVANIZED



**BMT/GMT
Reducer Series**



BMST/GSMT Series



BMCR/GMCR Series



BMRHC/GMRHC Series

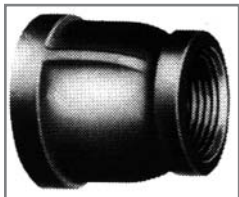

**BMRHC/GMRHC
Reducer Series**

Size	Ctn Qty	List Price
TEE Reducing, Cont. fipxfiptxfipt		
BMT3 x 3 x 3/4	8	\$ 143.57
BMT3 x 3 x 1	8	141.50
BMT3 x 3 x 1 1/4	8	149.08
BMT3 x 3 x 1 1/2	8	146.39
BMT3 x 3 x 2	8	140.81
BMT3 x 3 x 2 1/2	8	167.27
STREET TEE fipxmiptxfipt		
BMST3/4	20	16.30
BMST1	12	21.54
BMST1 1/4	10	35.55
CROSS fipt		
BMCR1/2	30	16.85
BMCR3/4	15	20.39
BMCR1	15	25.11
BMCR1 1/4	12	40.76
BMCR1 1/2	8	50.53
BMCR2	8	83.08
Right Hand Coupling fipxfipt		
BMRHC1/4	35	5.98
BMRHC3/8	40	5.98
BMRHC1/2	40	4.60
BMRHC3/4	40	5.40
BMRHC1	25/100	8.08
BMRHC1 1/4	15	10.47
BMRHC1 1/2	10	14.13
BMRHC2	8	20.95
BMRHC2 1/2	8	57.83
BMRHC3	8	78.18
BMRHC4	4	157.45
REDUCING COUPLING fipxfipt		
BMRC1/4 x 1/8 ☺	25	6.29
BMRC3/8 x 1/4	25	6.29
BMRC1/2 x 1/4	25	5.72
BMRC1/2 x 3/8	30	5.41
BMRC3/4 x 1/4	35	7.23
BMRC3/4 x 3/8	35	7.23
BMRC3/4 x 1/2	50/200	6.05
BMRC1 x 3/8	30	11.87
BMRC1 x 1/2	30	9.65
BMRC1 x 3/4	25	9.42
BMRC1 1/4 x 1/2	15	14.23
BMRC1 1/4 x 3/4	15	12.12
BMRC1 1/4 x 1	20	12.12

Size	Ctn Qty	List Price
TEE Reducing, Cont. fipxfiptxfipt		
GMT3 x 3 x 3/4	8	\$ 316.15
GMT3 x 3 x 1	8	226.61
GMT3 x 3 x 1 1/4	8	239.66
GMT3 x 3 x 1 1/2	8	235.08
GMT3 x 3 x 2	8	226.61
GMT3 x 3 x 2 1/2	8	263.93
STREET TEE fipxmiptxfipt		
GMST3/4	20	20.85
GMST1	12	32.96
GMST1 1/4	10	54.96
CROSS fipt		
GMCR1/2	30	23.91
GMCR3/4	15	29.13
GMCR1	15	40.20
GMCR1 1/4	12	60.43
GMCR1 1/2	8	70.70
GMCR2	8	133.92
Right Hand Coupling fipxfipt		
GMRHC1/4	35	8.32
GMRHC3/8	40	8.59
GMRHC1/2	40	6.58
GMRHC3/4	40	7.58
GMRHC1	100	12.41
GMRHC1 1/4	15	17.50
GMRHC1 1/2	10	19.89
GMRHC2	8	29.08
GMRHC2 1/2	8	89.01
GMRHC3	8	118.95
GMRHC4	4	252.62
REDUCING COUPLING fipxfipt		
GMRC1/4 x 1/8 ☺	25	8.53
GMRC3/8 x 1/4	25	8.53
GMRC1/2 x 1/4	25	7.66
GMRC1/2 x 3/8	30	7.96
GMRC3/4 x 1/4	35	9.68
GMRC3/4 x 3/8	35	9.68
GMRC3/4 x 1/2	50/200	8.52
GMRC1 x 3/8	30	18.44
GMRC1 x 1/2	30	14.20
GMRC1 x 3/4	25	13.19
GMRC1 1/4 x 1/2	15	23.57
GMRC1 1/4 x 3/4	15	18.37
GMRC1 1/4 x 1	20	18.01

☺ Steel



Malleable Iron Fittings - Domestic

BLACK

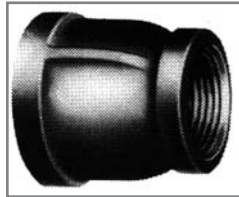

BMRHC/GMRHC
Reducer Series

Size	Ctn Qty	List Price
REDUCING COUPLING - con't fiptxfipt		
BMRC11/2 x 1/2	15	\$ 18.09
BMRC11/2 x 3/4	10	20.39
BMRC11/2 x 1	10	17.77
BMRC11/2 x 1 1/4	15	15.32
BMRC2 x 1/2	8	29.45
BMRC2 x 3/4	8	25.43
BMRC2 x 1	15	24.02
BMRC2 x 1 1/4	10	25.43
BMRC2 x 1 1/2	10	22.21
BMRC2 1/2 x 1 1/2	10	60.56
BMRC2 1/2 x 2	10	51.05
BMRC3 x 1	8	81.25
BMRC3x 1 1/4	8	82.76
BMRC3 x 1 1/2	8	79.77
BMRC3 x 2	8	66.07
BMRC3 x 2 1/2	8	77.14
BMRC4 x 2	4	159.91
BMRC4 x 3	4	159.91

HEX BUSHING miptxfipt

BMHB1/4 x 1/8 ☺	25	6.34
BMHB3/8 x 1/8 ☺	25	6.34
BMHB3/8 x 1/4 ☺	25	6.34
BMHB1/2 x 1/8 ☺	25	6.34
BMHB1/2 x 1/4 ☺	25	6.34
BMHB1/2 x 3/8 ☺	25	6.34
BMHB3/4 x 1/8	25	6.17
BMHB3/4 x 1/4	25	5.86
BMHB3/4 x 3/8	25	6.01
BMHB3/4 x 1/2	25	5.41
BMHB1 x 1/8	25	8.79
BMHB1 x 1/4	25	7.59
BMHB1 x 3/8	25	7.80
BMHB1 x 1/2	25	5.77
BMHB1 x 3/4	25/150	5.69
BMHB1 1/4 x 1/8	25	10.58
BMHB1 1/4 x 1/4	25	11.22
BMHB1 1/4 x 1/2	25	8.68
BMHB1 1/4 x 3/4	25	7.63
BMHB1 1/4 x 1	25	7.42
BMHB1 1/2 x 1/4	15	12.70
BMHB1 1/2 x 1/2	30	9.66
BMHB1 1/2 x 3/4	30	9.66
BMHB1 1/2 x 1	30	8.48
BMHB1 1/2 x 1 1/4	30	9.42
BMHB2x 1/4	20	13.69
BMHB2 x 1/2	20	15.34
BMHB2 x 3/4	20	12.13
BMHB2 x 1	20	11.59
BMHB2 x 1 1/4	20	11.59
BMHB2 x 1 1/2	20	11.86

☺ Steel

GALVANIZED

Size	Ctn Qty	List Price
REDUCING COUPLING - con't fiptxfipt		
GMRC11/2 x 1/2	15	\$ 27.78
GMRC11/2 x 3/4	10	23.68
GMRC11/2 x 1	10	23.68
GMRC11/2 x 1 1/4	15	22.37
GMRC2 x 1/2	8	40.12
GMRC2 x 3/4	8	38.68
GMRC2 x 1	15	32.30
GMRC2 x 1 1/4	10	34.15
GMRC2 x 1 1/2	10	32.30
GMRC2 1/2 x 1 1/2	10	95.27
GMRC2 1/2 x 2	10	90.12
GMRC3 x 1	8	126.59
GMRC3 x 1 1/4	8	126.59
GMRC3 x 1 1/2	8	119.77
GMRC3 x 2	8	113.19
GMRC3 x 2 1/2	8	115.58
GMRC4 x 2	4	259.14
GMRC4 x 3	4	259.14

HEX BUSHING miptxfipt

GMHB1/4 x 1/8 ☺	25	10.79
GMHB3/8 x 1/8 ☺	25	10.79
GMHB3/8 x 1/4 ☺	25	10.79
GMHB1/2 x 1/8 ☺	25	10.79
GMHB1/2 x 1/4 ☺	25	10.79
GMHB1/2 x 3/8 ☺	25	10.79
GMHB3/4 x 1/8	25	10.84
GMHB3/4 x 1/4	25	10.55
GMHB3/4 x 3/8	25	11.79
GMHB3/4 x 1/2	25	9.03
GMHB1 x 1/8	25	14.50
GMHB1 x 1/4	25	12.32
GMHB1 x 3/8	25	12.38
GMHB1 x 1/2	25	11.15
GMHB1 x 3/4	25/150	10.37
GMHB1 1/4 x 1/8	25	18.13
GMHB1 1/4 x 1/4	25	19.11
GMHB1 1/4 x 3/8	25	19.11
GMHB1 1/4 x 1/2	25	16.27
GMHB1 1/4 x 3/4	25	14.37
GMHB1 1/4 x 1	25	13.97
GMHB1 1/2 x 1/4	15	25.03
GMHB1 1/2 x 1/2	30	19.45
GMHB1 1/2 x 3/4	30	19.45
GMHB1 1/2 x 1	30	17.58
GMHB1 1/2 x 1 1/4	30	16.85
GMHB2x 1/4	20	28.34
GMHB2 x 1/2	20	24.39
GMHB2 x 3/4	20	22.67
GMHB2 x 1	20	22.67
GMHB2 x 1 1/4	20	22.67
GMHB2 x 1 1/2	20	19.56



BMHB/GMHB Series

Malleable Iron Fittings - Domestic



BLACK

GALVANIZED



BMHB/GMHB Series

Size	Ctn Qty	List Price
HEX BUSHING CONT. miptxfipt		
BMHB21/2 x 3/4	20	\$ 21.34
BMHB21/2 x 1	20	21.34
BMHB21/2 x 11/4	20	21.34
BMHB21/2 x 11/2	20	18.56
BMHB21/2 x 2	20	18.26
BMHB3x1/2	10	32.10
BMHB3 x 3/4	10	31.33
BMHB3 x 1	10	28.84
BMHB3 x 11/4	10	28.84
BMHB3 x 11/2	10	28.84
BMHB3 x 2	10	21.54
BMHB3 x 21/2	10	24.97
BMHB4 x 3/4	10	65.35
BMHB4 x 1	10	65.35
BMHB4 x 11/4	10	65.35
BMHB4 x 11/2	10	60.18
BMHB4 x 2	10	48.58
BMHB4 x 21/2	10	58.78
BMHB4 x 3	10	48.58

Size	Ctn Qty	List Price
HEX BUSHING CONT. miptxfipt		
GMHB21/2 x 3/4	20	\$ 41.28
GMHB21/2 x 1	20	41.28
GMHB21/2 x 11/4	20	41.28
GMHB21/2 x 11/2	20	37.16
GMHB21/2 x 2	20	32.54
GMHB3x1/2	10	54.46
GMHB3 x 3/4	10	54.46
GMHB3 x 1	10	54.46
GMHB3 x 11/4	10	53.19
GMHB3 x 11/2	10	49.01
GMHB3 x 2	10	42.35
GMHB3 x 21/2	10	45.46
GMHB4 x 3/4	10	107.64
GMHB4 x 1	10	114.13
GMHB4 x 11/4	10	114.13
GMHB4 x 11/2	10	114.13
GMHB4 x 2	10	88.91
GMHB4 x 21/2	10	114.13
GMHB4 x 3	10	88.91



BMFB/GMFB Series

Size	Ctn Qty	List Price
FLUSH BUSHING		
BMFB1 x 3/4	25	15.01
BMFB11/4 x 1	25	16.24

Size	Ctn Qty	List Price
FLUSH BUSHING		
GMFB1 x 3/4	25	25.30
GMFB11/4 x 1	25	31.31

Size	Ctn Qty	List Price
DOUBLE TAP BUSHING		
BMDTB2X11/4	20	23.98

Size	Ctn Qty	List Price
DOUBLE TAP BUSHING		
GMDTB2X1X1	20	39.96
GMDTB2X11/4X11/4	20	39.96



BMCA/GMCA Series

Size	Ctn Qty	List Price
CAP fipt		
BMCA1/4 ☺	40	4.34
BMCA3/8 ☺	40	3.46
BMCA1/2	50	3.37
BMCA3/4	40	4.57
BMCA1	25	5.52
BMCA11/4	25	7.27
BMCA11/2	20	10.00
BMCA2	10	14.58
BMCA21/2	6	33.22
BMCA3	6	49.37
BMCA4	5	84.63

Size	Ctn Qty	List Price
CAP fipt		
GMCA1/4 ☺	40	5.84
GMCA3/8 ☺	40	6.04
GMCA1/2	50	4.97
GMCA3/4	40	6.88
GMCA1	25	8.53
GMCA11/4	25	11.23
GMCA11/2	20	14.39
GMCA2	10	20.15
GMCA21/2	6	58.52
GMCA3	6	70.92
GMCA4	5	156.68

☺ Steel



Malleable Iron Fittings - Domestic

BLACK

GALVANIZED

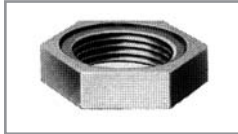

BMLN/GMLN Series

Size	Ctn Qty	List Price
LOCK NUT		
BMLN1/8 ☺	50	5.31
BMLN1/4 ☺	50	4.89
BMLN3/8	50	5.55
BMLN1/2	50	4.76
BMLN3/4	50	5.20
BMLN1	40	9.96
BMLN11/4	40	8.19
BMLN11/2	40	11.50
BMLN2	25	19.08

Size	Ctn Qty	List Price
LOCK NUT		
GMLN1/8 ☺	50	6.04
GMLN1/4 ☺	50	5.60
GMLN3/8	50	6.96
GMLN1/2	50	5.63
GMLN3/4	50	6.59
GMLN1	40	12.01
GMLN11/4	40	11.52
GMLN11/2	40	14.95
GMLN2	25	26.33



BMP/GMP Series

Size	Ctn Qty	List Price
Square Head Plug mipt		
BMP1/8 ☺	100	\$ 1.02
BMP1/4 ☺	100	1.02
BMP3/8 ☺	100	1.02
BMP1/2 ☺	100	1.11
BMP3/4 ☺	100	1.23
BMP1	40	3.11
BMP11/4	40	4.96
BMP11/2	40	7.03
BMP2	40	8.20
BMP21/2	20	19.96
BMP3	10	23.12
BMP4	5	47.62
BMP5		89.52

Size	Ctn Qty	List Price
Square Head Plug mipt		
GMP1/8 ☺	100	\$ 1.52
GMP1/4 ☺	100	1.54
GMP3/8 ☺	100	1.54
GMP1/2 ☺	100	1.66
GMP3/4 ☺	100	1.79
GMP1	40	6.65
GMP11/4	40	11.10
GMP11/2	40	15.00
GMP2	40	18.62
GMP21/2	20	39.35
GMP3	10	50.40
GMP4	5	97.74
GMP5		194.31

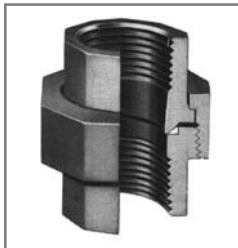

BMU/GMU Series

Size	Ctn Qty	List Price
Unions, 150 lbs UL Listed		
BMU150-1/8	25	25.52
BMU150-1/4	35	23.60
BMU150-3/8	35	16.26
BMU150-1/2	40/160	14.73
BMU150-3/4	30/60	16.92
BMU150-1	25/50	22.07
BMU150-11/4	15	31.65
BMU150-11/2	12	39.47
BMU150-2	8	45.89
BMU150-21/2	8	136.71
BMU150-3	8	164.57
BMU150-4	1	429.19

Size	Ctn Qty	List Price
Unions, 150 lbs UL Listed		
GMU150-1/8	25	36.37
GMU150-1/4	35	32.02
GMU150-3/8	35	21.43
GMU150-1/2	40/160	19.56
GMU150-3/4	30/60	22.47
GMU150-1	25/50	29.42
GMU150-11/4	15	42.54
GMU150-11/2	12	51.54
GMU150-2	8	59.25
GMU150-21/2	8	205.84
GMU150-3	8	288.10
GMU150-4	1	616.73



BMFF/GMFF Series

Size	Ctn Qty	List Price
FLOOR FLANGE (diameter)		
BMFF1/4 2 3/8"	25	10.32
BMFF3/8 2 15/16"	25	10.32
BMFF1/2 3"	30	12.60
BMFF3/4 3 1/4"	30	13.33
BMFF1 3 7/8"	30	17.27
BMFF11/4 3 7/8"	30	17.73
BMFF11/2 4 1/2"	10	19.49
BMFF2 5 1/2"	15	25.46
BMFF21/2 5 13/16"	10	33.16
BMFF3 6 3/8"	10	41.87

Size	Ctn Qty	List Price
FLOOR FLANGE (diameterter)		
GMFF1/4 2 3/8"	25	20.06
GMFF3/8 2 15/16"	25	20.06
GMFF1/2 3"	30	30.11
GMFF3/4 3 1/4"	30	32.88
GMFF1 3 7/8"	30	37.00
GMFF11/4 3 7/8"	30	42.18
GMFF11/2 4 1/2"	10	52.75
GMFF2 5 1/2"	15	69.40
GMFF21/2 5 13/16"	10	93.20
GMFF3 6 3/8"	10	90.96

☺ Steel



In the United States: Phone (800) 776-2266 Fax (800) 729-3299
 In Canada: Phone (866) 503-5523 Fax (888) 562-2095

www.americangranby.com

10/24/08

12.45

